

**Legend**

- K Lithium in Formation Waters (Hitchon et. al.)
- ) Cities
- Highways
- Brine Producability Area (after Hamilton et. al. 1999)
- Lithium Bearing Formation Water (after Hamilton et. al. 1999)

**Mineral Tenures**

**877384 Alberta Ltd.**

- South Property
- North Property
- Central Property
- Other
- Robin Charles Day

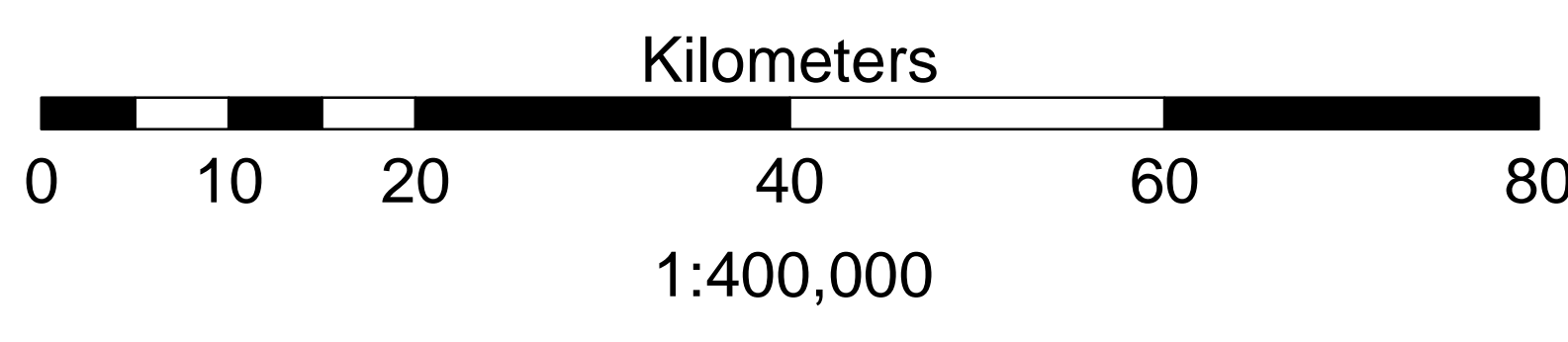

**DG** Dahrouge Geological Consulting Ltd.  
Edmonton, Alberta

Western Alberta  
Lithium Lands

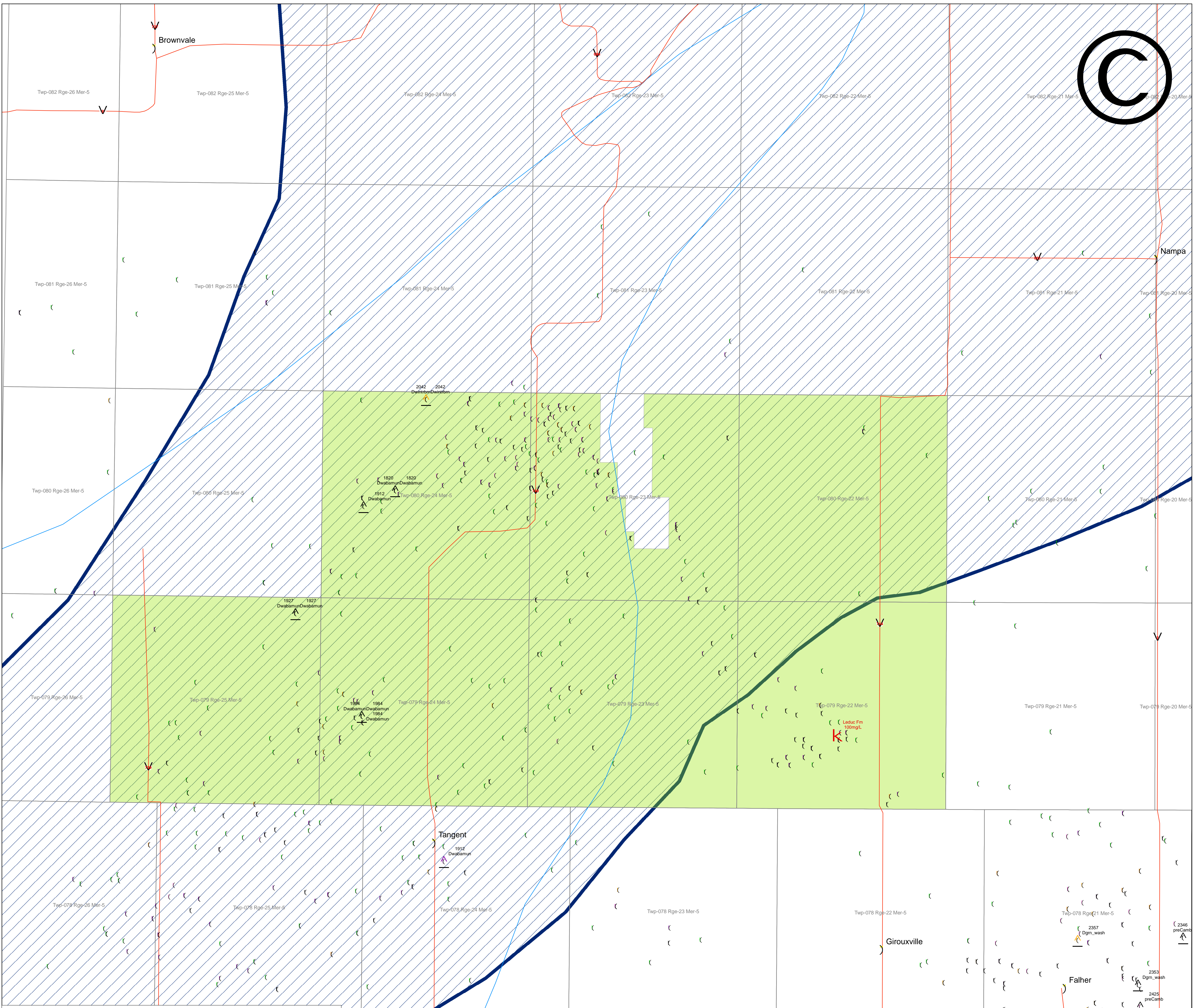
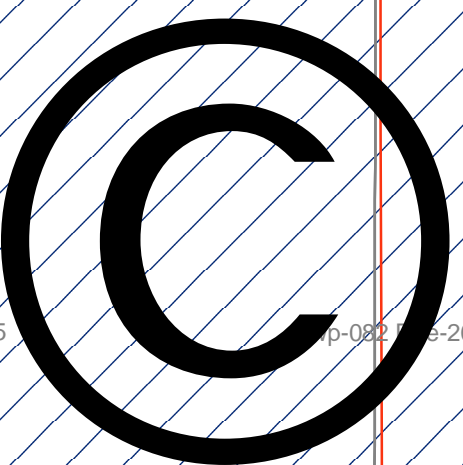

**Legend**

**K** Lithium in Formation Waters (Hitchon et. al.)

**Recently Drilled**

- Abandoned
- Drilled and Cased
- Drilled and Abandoned
- Active

**Wells that Pierce the Devonian**

- Abandoned
- Drilled and Cased
- Drilled and Abandoned
- Active
- Suspended
- Cities

Highways

Brine Producibility Area (after Hamilton et. al. 1999)

Lithium Bearing Formation Water (after Hamilton et. al. 1999)

**Mineral Tenures**

- Other Permits
- 877384 Alberta Ltd.

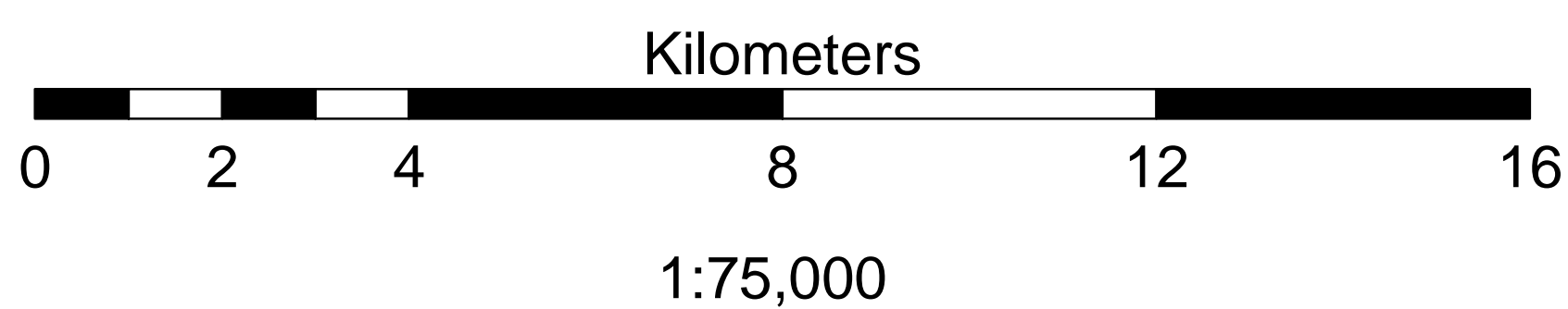

**DG** Dahrouge Geological Consulting Ltd.  
Edmonton, Alberta

Northern Lithium Property

PK

2008.07

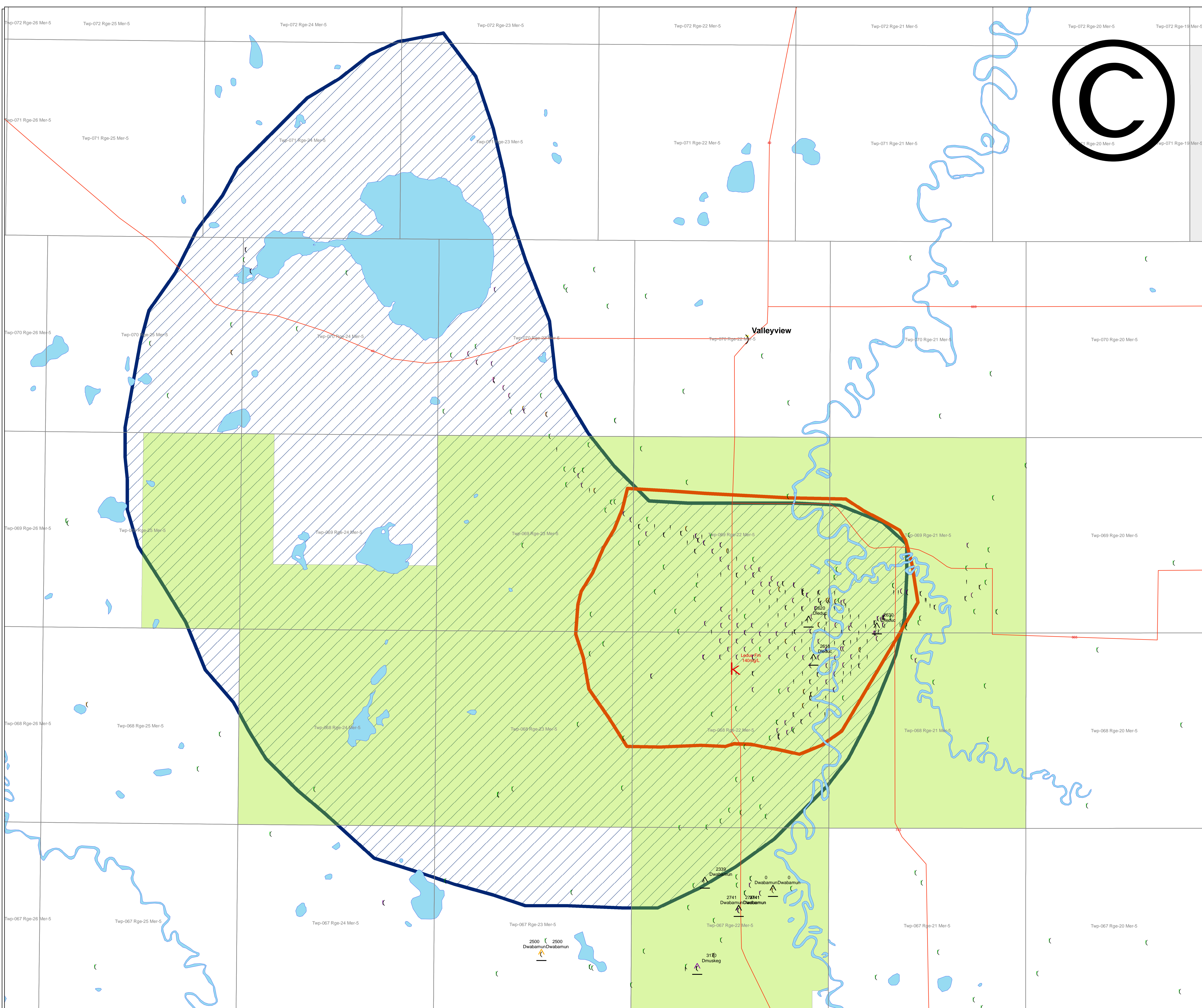
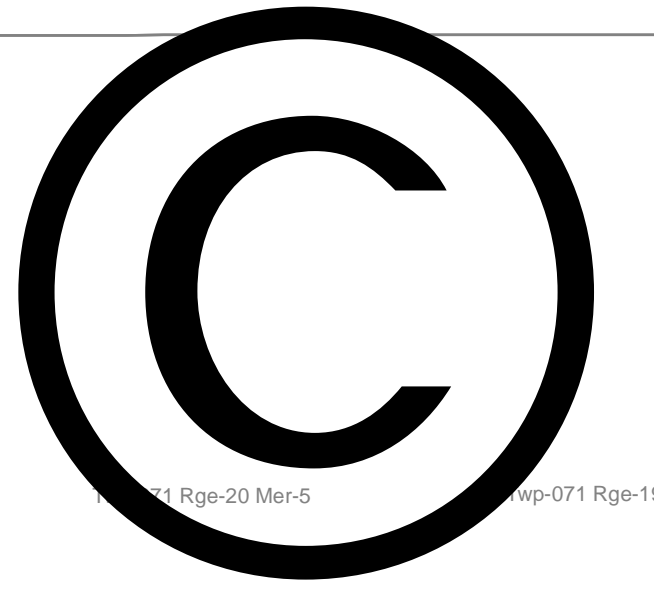

### Legend

Lithium in Formation Waters (Hitchon et. al.)

#### Recently Drilled

- Abandoned
- Drilled and Abandoned
- Active

#### Wells that Pierce the Devonian

- Abandoned
- Drilled and Cased
- Drilled and Abandoned
- Active
- Suspended
- Cities

Highways

Brine Producibility Area (after Hamilton et. al. 1999)

Lithium Bearing Formation Water (after Hamilton et. al. 1999)

#### Mineral Tenures

- Other Permits
- 877384 Alberta Ltd.

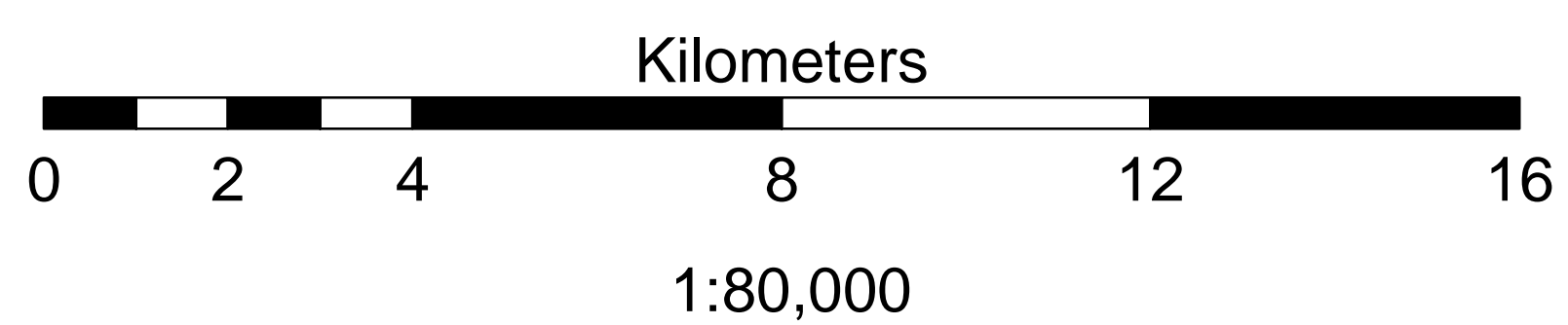

Dahrouge Geological Consulting Ltd.  
Edmonton, Alberta

Central Lithium Property

PK

2008.07

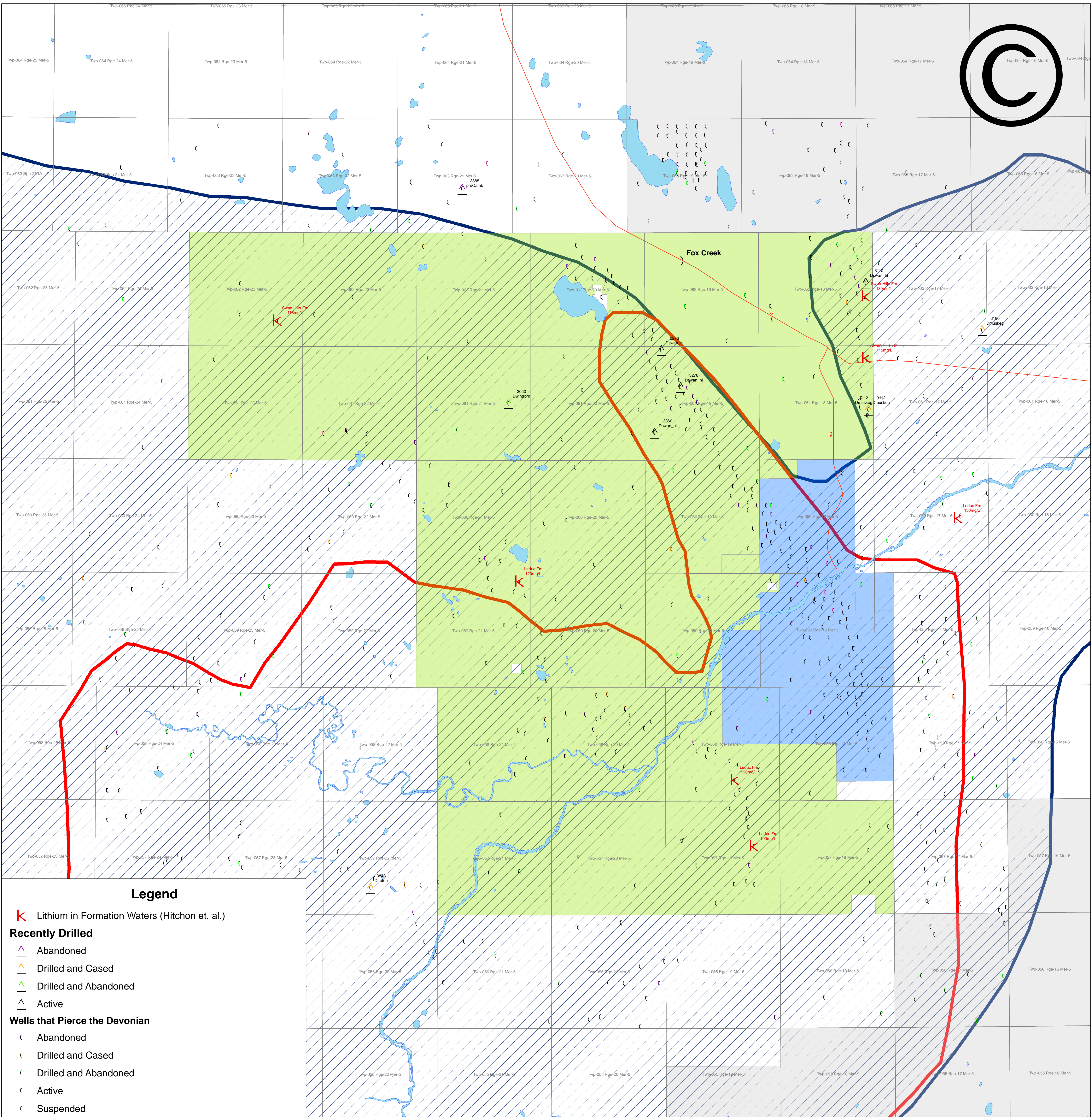
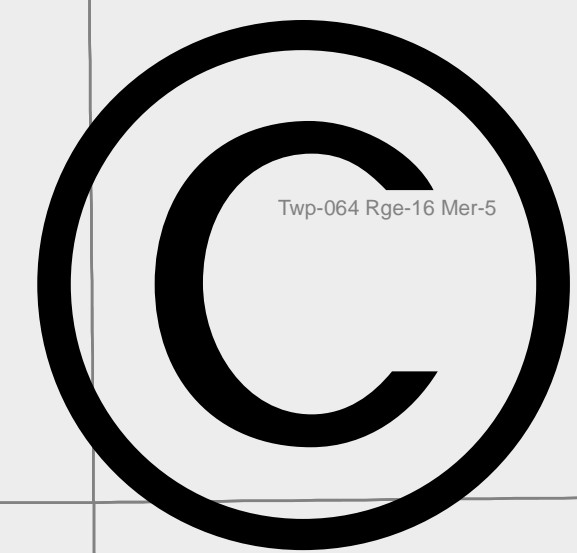

**Legend**

- K Lithium in Formation Waters (Hitchon et. al.)
- Recently Drilled**
  - ^ Abandoned
  - ^ Drilled and Cased
  - ^ Drilled and Abandoned
  - ^ Active
- Wells that Pierce the Devonian**
  - ( Abandoned
  - ( Drilled and Cased
  - ( Drilled and Abandoned
  - ( Active
  - ( Suspended
  - ( Test/Observation
  - ) Cities
- Highways
- Brine Producability Area (after Hamilton et. al. 1999)
- Lithium Bearing Formation Water (after Hamilton et. al. 1999)
- Mineral Tenures**
  - Other Permits
  - Robin Charles Day
  - 877384 Alberta Ltd.

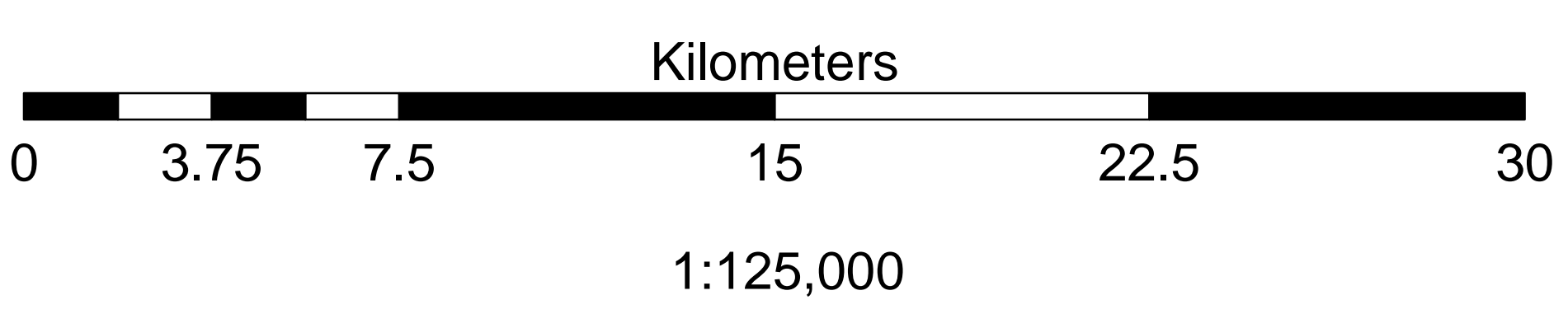

**Dahrouge Geological Consulting Ltd.**  
Edmonton, Alberta

**Southern Lithium Property**